

ORIGINATION:

THIS IS TO CERTIFY THAT THE SERVITUDES AND ADDITIONAL RIGHT-OF-WAY FOR STARRING LANE SHOWN ON THIS PLAT ARE HEREBY DEDICATED TO THE PERPETUAL USE OF THE PUBLIC FOR PROPER PURPOSES INCLUDING DRAINAGE AND ALL UTILITIES.

Alton L. Lea
ALTON L. LEA, OWNER

NOTES:

1. IRON PIPES PLACED AT ALL CORNERS.
2. THE LOTS SHOWN ON THIS PLAT ARE SUBJECT TO RESTRICTIONS FILED IN ORIGINAL BUNDLE IN THE OFFICE OF THE CLERK OF COURT, EAST BATON ROUGE PARISH, LA.
3. THE METHOD OF SEWAGE TREATMENT AND DISPOSAL AND THE SOURCE OF THE WATER SUPPLY SHALL BE APPROVED BY THE EAST BATON ROUGE PARISH HEALTH UNIT.

FINAL PLAT OF
LAUREL-LEA SUBDIVISION

BEING THE SUBDIVISION OF THE REMAINING PORTION OF THE G. B. KIMBRO TRACT LOCATED IN SECTION 66, T-8-S, R-1-E, S. L. D. OF LOUISIANA IN THE PARISH OF EAST BATON ROUGE, LOUISIANA

FOR:
ALTON L. LEA, OWNER

RECOMMENDED APPROVAL: *Richard A. McEwen*
RICHARD A. MCEWEN, PLANNING ENGINEER, PLANNING COMMISSION, BATON ROUGE, EAST BATON ROUGE PARISH, LOUISIANA.
DATE: 12/16/53

RECOMMENDED APPROVAL: *J. Lester White*
J. LESTER WHITE, DIRECTOR, CITY-PARISH DEPT. OF PUBLIC WORKS, BATON ROUGE, EAST BATON ROUGE PARISH, LOUISIANA.
DATE: 12/16/53

APPROVED: *Clyde P. Didier*
CLYDE P. DIDIER, PARISH CLERK, EAST BATON ROUGE PARISH, LA.
DATE: 12/22/53

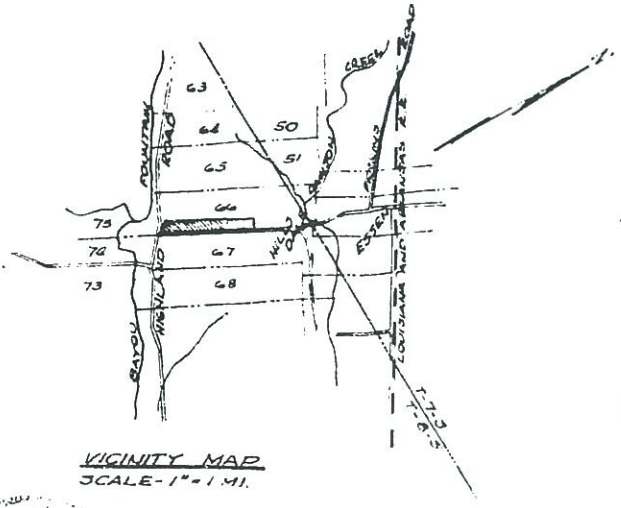

THIS IS TO CERTIFY THAT THIS PLAT IS MADE IN ACCORDANCE WITH ACT 51 OF 1930 AND CONFORMS TO ALL PARISH ORDINANCES GOVERNING THE SUBDIVISION OF LAND.

John Craft
JOHN CRAFT, CIVIL ENGR.